



# FRAME

NATURAL CONCEPT FOR  
MODERN ARCHITECTURE

 **LANDMARK**  
CERAMICS

# LANDMARK

## STONE

“Stone” is a gathering of porcelain tile collections that are inspired by different natural stones. Amazing surfaces for floors and walls that recall the shades of the natural material enhancing architecture and design with character and intense elegance. The excellent technical characteristics of Landmark porcelain tile guarantees optimal performance in every intended use both residential and commercial.

### A new landmark in the ceramic industry

Landmark Ceramics is an American company, based in Tennessee that has set out to research, manufacture and sell top quality porcelain ceramics in North America. Technological innovation, market presence, attention to detail, the welfare of people and the environment, efficient service and a thorough product range make Landmark a new benchmark in the North American market for those who are looking for a reliable partner for any building and architecture project using US made top quality porcelain material.



Frame is the porcelain collection that highlights a **strong architectural style** with balanced graphics. A contemporary color palette, earthy tone shades, from light white to warm dark gray, **reproduce the finest natural limestones**, characterized by a homogeneous texture with very slight inclusions and grains and an elegant presence of veining.





# DEFINE YOUR VISION

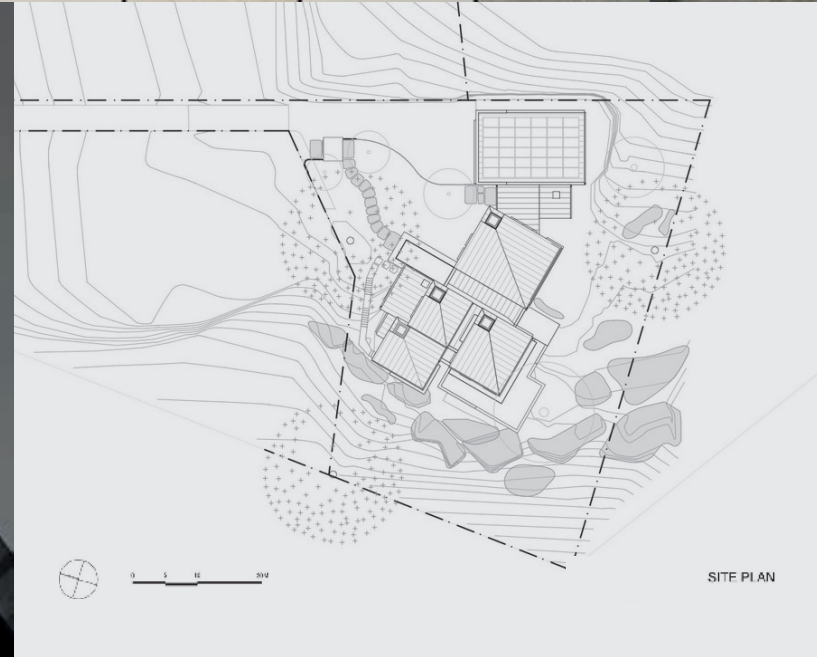

With Frame porcelain tiles and pavers you can **focus and enhance multiple inspirations** in any kind of project, to shape your setting in **commercial** and **residential** areas, both **indoors** and **outdoors**. The essential graphic of the surfaces expresses the inspiration material through a minimalist design, to unleash creativity thanks to the highest technical performance of Landmark's porcelain.



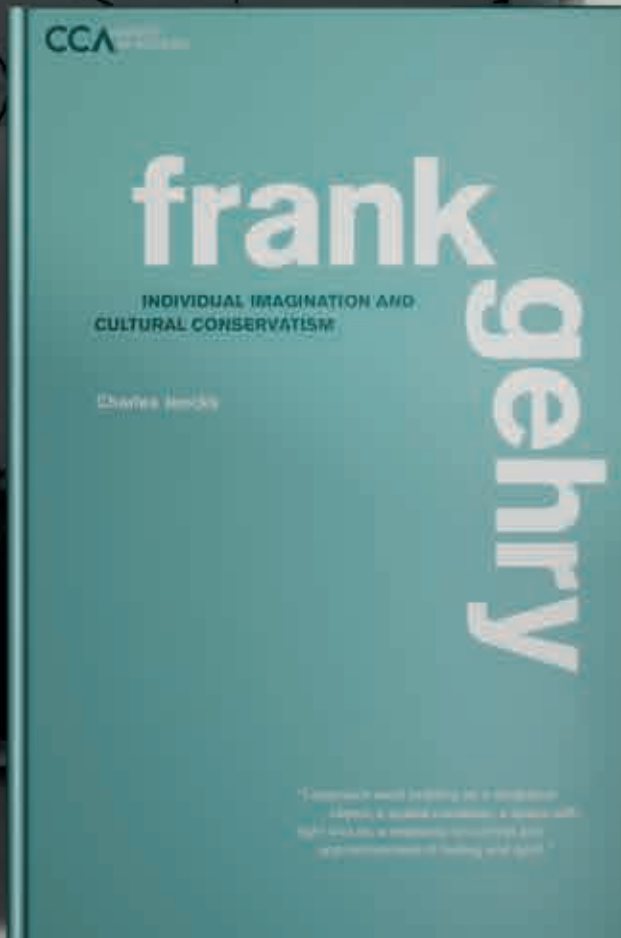
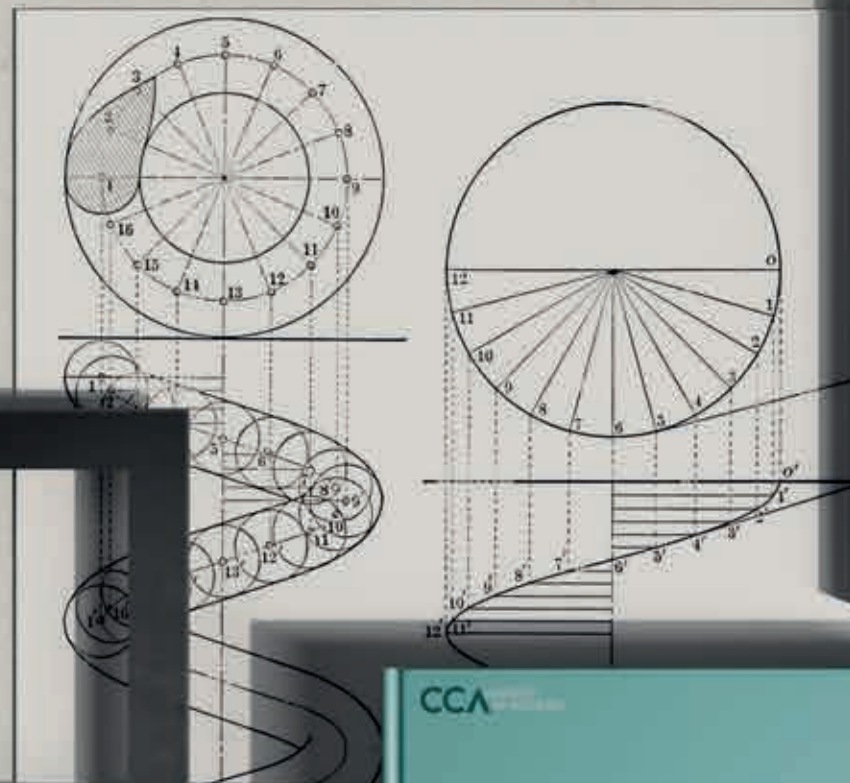

## DOWNTOWN DUPLEX APARTMENT

Warm and dark shades inspired by natural limestone dialogue perfectly with each other thanks to the **versatile modular formats**, creating refined interior environments in residential projects as well as commercial.

**Matching 20 mm porcelain pavers allow in & out transitions** for a total look style. Smooth colorations, detailed graphic, and warm tones make Frame one of a kind limestone look for every contemporary space.

- 01 Frame Rationalist Dark
- 02 Frame Minimalist Greige
- 03 Frame Hexagon Multicolor Light - Mosaic D





**PROJECT**

- OUTDOOR FLOOR DESIGN
- Frontier20 Minimalist Greige - 24"x24"
- INDOOR FLOOR DESIGN
- Frame Minimalist Greige - 24"x48"
- Frame Hexagon Multicolor Light Mosaic D - 12"x10"
- WALL DESIGN
- Frame Minimalist Greige - 24"x48"
- Frame Rationalist Dark - 12"x24"





**PROJECT**  
 OUTDOOR FLOOR DESIGN  
 Frontier20 Minimalist Greige - 24"x24"  
 INDOOR FLOOR DESIGN  
 Frame Minimalist Greige - 24"x48"

# INTERIOR VIBES

The Hexagon Mosaic creates a **multicolor geometric surface**, blending three distinct hues. It can be laid **over walls and floors**, to graciously design every type of ambient with unique preciousness. The decorative range is completed by a traditional squared mosaic and enhanced with a trapezoidal one.



**PROJECT**  
 INDOOR FLOOR DESIGN  
 Frame Minimalist Greige - 24"x48"  
 Frame Hexagon Multicolor Light Mosaic D - 12"x10"



# 02

## LUXURY RESORT & SUITE

Colors and graphics of natural limestone converge on Frame surfaces, providing **indoor and outdoor matching solutions** with 20mm porcelain pavers and traditional 9 mm thickness floors. Porcelain mosaics expand design possibilities with appealing wall decorations. **Natural beauty has never been so strong:** stronger than granite and marble, harder than stone. No sealing needed, no discolorations, stain resistant, and so many more advantages for your spaces.

01 03

- 01 Frame Neoclassical Beige
- 02 Frame International White
- 03 Frame Geometric Multicolor Light - Mosaic G
- 04 Frame Neoclassical Beige - Mosaic A

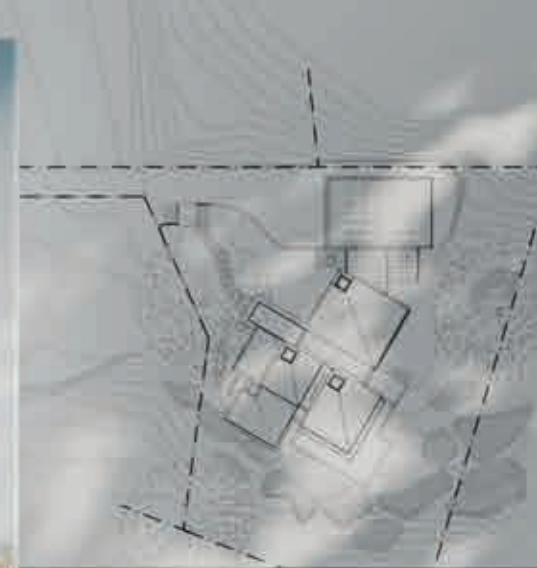

04

02







**PROJECT**  
OUTDOOR FLOOR DESIGN  
Frontier20 International White - 24"x24"  
Frontier20 Minimalist Greige - 24"x24"  
WALL DESIGN  
Frame International White - 24"x48"  
Frame Neoclassical Beige - 24"x48"



FRAME



**PROJECT**  
OUTDOOR FLOOR DESIGN  
Frontier20 International White - 24"x24"  
Frontier20 Minimalist Greige - 24"x24"



**PROJECT**  
OUTDOOR FLOOR DESIGN  
Frontier20 Minimalist Greige - 24"x24"  
WALL DESIGN  
Frame International White - 24"x48"

## OUTDOOR EXPRESSION

A range of **coordinated special trims** allows to shape the outdoor project in every detail, such as stairs, walls, and pool areas. The resistance of 20 mm porcelain pavers ensures the **highest performances** wherever safety is a priority. Frame does not fear extreme weather conditions, fire, or everyday chemicals. Porcelain paver is the ultimate frontier of outdoor application for architecture landscaping.





**PROJECT**

OUTDOOR FLOOR DESIGN  
Frontier20 International White - 24"x24"  
INDOOR FLOOR DESIGN  
Frame Neoclassical Beige - 12"x24"  
Frame Neoclassical Beige Mosaic A - 12"x12"  
WALL DESIGN  
Frame Neoclassical Beige - 12"x24"  
Frame Neoclassical Beige Mosaic A - 12"x12"  
Frame Geometric Multicolor Light Mosaic G - 13.7"x12"





**PROJECT**  
 FLOOR DESIGN  
 Frame Neoclassical Beige Mosaic A - 12"x12"  
 WALL DESIGN  
 Frame Geometric Multicolor Light Mosaic G - 13.7"x12"

# WELL-BEING MOOD

With limestone neutral shades, you can achieve a bright, elegant look in every space. Porcelain surfaces are hygienic and hypoallergenic, resistant to water, and can be cleaned very easily. **Resistance, easy maintenance, and sustainability** is all in one with Frame. There is no match with any other flooring solutions when it comes to health and environment. Choose to live surrounded by the highest quality material for you and for the world.



**PROJECT**  
 FLOOR DESIGN  
 Frame Neoclassical Beige - 12"x24"  
 WALL DESIGN  
 Frame Neoclassical Beige - 12"x24"  
 Frame Neoclassical Beige Mosaic A - 12"x12"



# 03

## METROPOLITAN CAFÉ & RESTAURANT

Minimal graphics enriched by light inclusions open up a new perspective for contemporary design. Frame is perfect for **total application** in commercial spaces, including transitional areas where **high resistance** to impact, scratching, and trampling is required. With its warm and neutral color palette, the collection envelops the space with the soft shades of limestone, conveying an **exclusive personality**.

- 01 Frame Expressive Taupe
- 02 Frame International White
- 03 Frame Hexagon Multicolor Light - Mosaic D

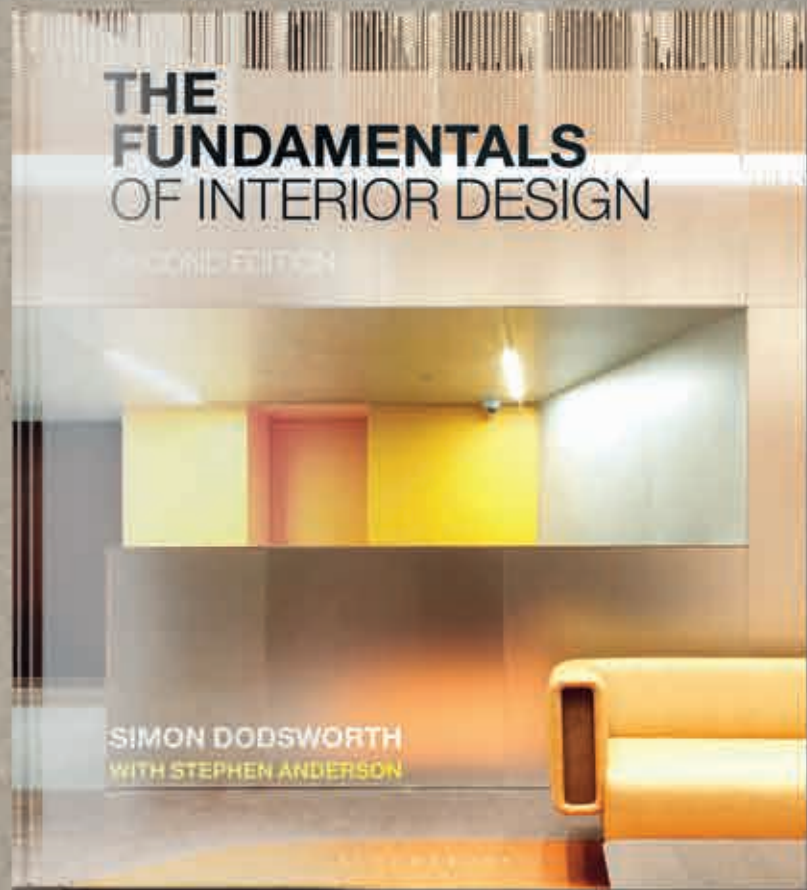

01

02



03





**PROJECT**  
FLOOR DESIGN  
Frame International White - 24"x48"  
Frame Expressive Taupe - 12"x24"  
WALL DESIGN  
Frame Hexagon Multicolor Light Mosaic D - 12"x10"





**PROJECT**  
 FLOOR DESIGN  
 Frame Expressive Taupe - 12"x24"  
 WALL DESIGN  
 Frame Hexagon Multicolor Light Mosaic D - 12"x10"



**PROJECT**  
 FLOOR DESIGN  
 Frame International White - 24"x48"  
 Frame Expressive Taupe - 12"x24"

# ABSOLUTE PERFORMANCES

Frame lets you **design any setting** without worrying about anything. Porcelain tiles and pavers are **scratch** and **dent resistant**, **waterproof**, and easy to clean. Contrasting colors allow spaces to be divided according to their intended use, while decors can be applied to walls to make a scenographic focal point.





03



01

02



04

## LAW FIRM CONFERENCE ROOM

Dedicated to refined interior spaces with elegant taste, Frame brings to life a **skillful play of mix and match surfaces**. In addition to the typical gray color of natural limestone, the palette includes a dark, bold shade perfect for urban settings. The **neutral tones** of the material become the key element in designing an understated look.

- 01 Frame Rationalist Dark
- 02 Frame Minimalist Greige
- 03 Frame Geometric Multicolor Dark - Mosaic G







**PROJECT**

FLOOR DESIGN

Frame Rationalist Dark - 12"x24"

Frame Minimalist Greige - 24"x48"

WALL DESIGN

Frame Rationalist Dark - 12"x24"

Frame Geometric Multicolor Dark Mosaic G - 13.7"x12"





FRAME

**PROJECT**

FLOOR DESIGN

Frame Rationalist Dark - 12"x24"

Frame Minimalist Greige - 24"x48"

# ELEGANCE IS IN DETAILS

Mosaic G enhances the wall with **trapezoidal inserts** of the same color gradation, in the grayscale. The tiles, laid in random order, create different and original optical patterns adding a touch of contemporary decoration to interior walls.



**PROJECT**

FLOOR DESIGN

Frame Rationalist Dark - 12"x24"

WALL DESIGN

Frame Geometric Multicolor Dark Mosaic G - 13.7"x12"



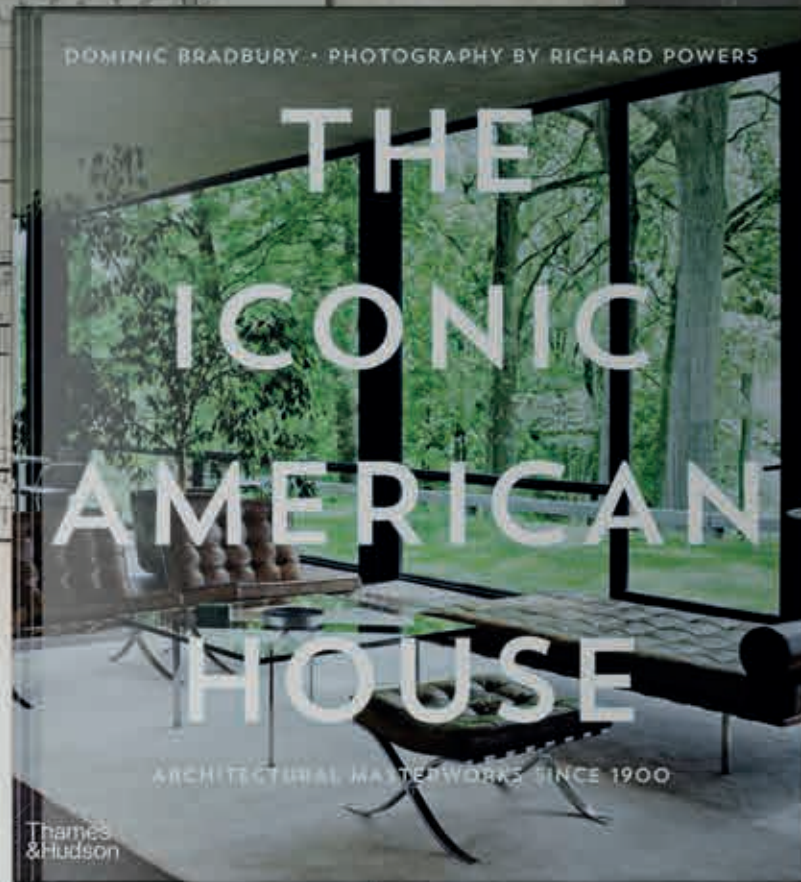

- 01 Frame International White
- 02 Frame Rationalist Dark
- 03 Frame Hexagon Multicolor Light - Mosaic D



# 05

## OPEN AIR LIVING ROOM

The natural character of limestone effect evokes cozy atmospheres, creating environments with a **relaxed elegance**. Combining aesthetics and performance, Frame porcelain tiles and pavers are a **mix of beauty, resistance, and durability** offering a comprehensive solution for architects and interior designers.





**PROJECT**

OUTDOOR FLOOR DESIGN

Frontier20 International White - 24"x24"

INDOOR FLOOR DESIGN

Frame International White - 24"x48"

WALL DESIGN

Frame International White - 24"x48"

Frame Hexagon Multicolor Light Mosaic D - 12"x10"

Veneer World Urban LedgeStone Explore Volcanic Black - 6"x24"





## A HEALTHY MATERIAL

With Frame you can handle the little problems of everyday life. Porcelain surfaces do not absorb and **stay hygienic** for a long time with ease. You can simply clean porcelain tiles and decors with common detergents.

**PROJECT**  
WALL DESIGN  
Frame Hexagon Multicolor Light Mosaic D - 12"x10"



## A SAFE CHOICE

Landmark porcelain tiles and pavers are **fireproof**. They can be laid in areas around fireplaces and fire pits because in contact with open flames they do not burn and do not release smoke or harmful substances. Safety is the new top of mind when you think about porcelain.



**PROJECT**  
OUTDOOR FLOOR DESIGN  
Frontier20 International White - 24"x24"  
INDOOR FLOOR DESIGN  
Frame International White - 24"x48"



**SUSTAINABILITY**



**RECYCLABLE**

Tiles can be recycled inside the production process when not fired yet, or once they have finished their life-cycle can be used as compact base material on the contrary many plastic base material such as vinyl cannot.

**SUSTAINABILITY**



**ECO-FRIENDLY AND SAFE**

**SUSTAINABILITY**



**ENERGY EFFICIENT**

Tile's inherent thermal mass reduces peak heating and cooling, which helps moderate temperature swings in your home.

**HEALTH**



**NATURAL INGREDIENTS**

Tile is made of clays and other naturally-occurring minerals and does not contain chemicals with potential adverse health effects (pvc, voc, formaldehyde, plastic etc...)

**SAFETY/DURABILITY**



**SCRATCH AND DENT RESISTANT**

Tile is strong, hard and resistant to most type of scratches. Tile also, being an extremely dense material, doesn't fear any denting damage, like many others flooring materials do.

**SAFETY/DURABILITY**



**FADE AND UV RESISTANT**

**SUSTAINABILITY**



**FLOOR HEAT FRIENDLY**

**SUSTAINABILITY**



**VERY LONG SERVICE LIFE**

Tile when properly installed and maintained can last for decades.

**SUSTAINABILITY**



**COST SAVING OVER TIME**

Thanks to its long service life and easy maintenance, porcelain tile is very cost effective over time when compared to flooring products that need to be replaced more frequently.

**SAFETY/DURABILITY**



**RESISTANT TO ACID**

**SAFETY/DURABILITY**



**WATER PROOF**

Tile is very compact and impervious therefore doesn't absorb. With tile you'll never have to worry about water.

**SAFETY/DURABILITY**



**FIRE PROOF**

Tile doesn't burn, melt or give off toxic fumes when exposed to fire.

**HEALTH**



**PREVENT BACTERIA GROWTH**

Tile is completely inhospitable to bacteria. That means no mold or mildew, and a healthier home for you.

**HEALTH**



**ZERO ALLERGENES**

Tile is both hard and impervious therefore inhospitable to dust mites, bacteria, fungi, mold and other irritants.

**HEALTH**



**ZERO SMOKE DEVELOPMENT**

Tile never gives off toxic fumes, even when exposed to fire.

**SAFETY/DURABILITY**



**DOESN'T BEND**

Tile is hard and compact.

**SAFETY/DURABILITY**



**PET FRIENDLY**

Tile is both dog and cat scratch proof.

**SAFETY/DURABILITY**



**RESISTANT TO FROST**

Tile is snow and ice proof.

**HEALTH**



**ZERO FORMALDEHYDE**

Formaldehyde is known to lead to an increased incidence of asthma. Tile has zero formaldehyde.

**HEALTH**



**ZERO PVC ZERO VOC**

Tile is completely PVC and VOC (volatile organic compound) free that means a healthier home for you.

**HEALTH**



**PLASTIC FREE**

Tiles are free from any PBM (Plastic Base Material) materials used in vinyl and LVT.

**EASY CARE**



**STAIN RESISTANCE**

**EASY CARE**



**EASY TO KEEP CLEAN**

**VERSATILITY**



**FLOOR AND WALL**

Tile is ideal for both floor and wall application indoor and outdoor.



COLORED BODY PORCELAIN TILE - Rectified Monocaliber

MATT FINISH

INTERNATIONAL WHITE



Available sizes

Color shading



24"x48"  
MATT  
± 0.35" / 9 mm

12"x24"  
MATT  
± 0.35"

12"x12"  
MATT  
MOSAIC A  
± 0.35"

NEOCLASSICAL BEIGE



Available sizes

Color shading



24"x48"  
MATT  
± 0.35"

12"x24"  
MATT  
± 0.35"

12"x12"  
MATT  
MOSAIC A  
± 0.35"

MINIMALIST GREIGE



Available sizes

Color shading



24"x48"  
MATT  
± 0.35"

12"x24"  
MATT  
± 0.35"

12"x12"  
MATT  
MOSAIC A  
± 0.35"

RATIONALIST DARK



Available sizes

Color shading



12"x24"  
MATT  
± 0.35"

12"x12"  
MATT  
MOSAIC A  
± 0.35"

EXPRESSIVE TAUPE



Available sizes

Color shading



12"x24"  
MATT  
± 0.35"

12"x12"  
MATT  
MOSAIC A  
± 0.35"

The color of tiles printed in this catalog may differ from actual tiles. Tile color reproductions in this catalog are representative only. Slight tone and shade variations are inherent in porcelain tiles. Before selecting a color, we recommend that you contact your local representative, who will provide you with a sample piece of the requested tile.

This porcelain tile product is manufactured with a V2 shade variation. Remember that the amount of color as well as the texture of each piece may vary from tile to tile. Inspect the product immediately upon delivery and select tiles from many boxes during installation to minimize and blend any possible color difference.

Color Shading



UNIFORM APPEARANCE



SLIGHT VARIATION



MODERATE VARIATION



SUBSTANTIAL VARIATION



# FRAME

COLORED BODY PORCELAIN TILE - Rectified Monocaliber

## PORCELAIN MOSAICS

MATT FINISH



International White  
Mosaic A  
2"x2" - 12"x12"



Minimalist Greige  
Mosaic A  
2"x2" - 12"x12"



Neoclassical Beige  
Mosaic A  
2"x2" - 12"x12"

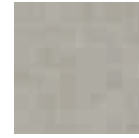

Expressive Taupe  
Mosaic A  
2"x2" - 12"x12"



Rationalist Dark  
Mosaic A  
2"x2" - 12"x12"

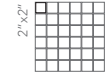

2"x2"  
12"x12"  
MOSAIC A  
±0.35" / 9 mm



Hexagon  
Multicolor Light \*  
Mosaic D  
3.15"x2.8" - 12"x10"



Hexagon  
Multicolor Dark \*\*  
Mosaic D  
3.15"x2.8" - 12"x10"



3.15"x2.8"  
12"x10"  
MOSAIC D  
±0.35"



Geometric  
Multicolor Light \*  
Mosaic G  
13.7"x12"



Geometric  
Multicolor Dark \*\*  
Mosaic G  
13.7"x12"

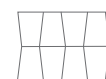

13.7"x12"  
MOSAIC G  
±0.35"

\* Matches with



International  
White



Neoclassical  
Beige



Expressive  
Taupe

\*\* Matches with



International  
White



Minimalist  
Greige



Rationalist  
Dark

## TRIM TILES

MATT FINISH

COORDINATED COVE BASE FROM VISION AND VISION COLOR COLLECTIONS



BULLNOSE 3"x24"



COVE BASE 6"x12"

INTERNATIONAL WHITE	●	VISION PEARL / VISION DARK / VISION COLOR STAR WHITE
MINIMALIST GREIGE	●	VISION PEARL / VISION COLOR STAR WHITE
NEOCLASSICAL BEIGE	●	VISION DOVE / VISION TAUPE / VISION COLOR STAR WHITE
EXPRESSIVE TAUPE	●	VISION TAUPE / VISION COLOR STAR WHITE
RATIONALIST DARK	●	VISION DARK / VISION COLOR STAR BLACK / VISION COLOR STAR WHITE



### PROJECT

FLOOR DESIGN

Frame Neoclassical Beige Mosaic A - 12"x12"

WALL DESIGN

Frame Geometric Multicolor Light Mosaic G - 13.7"x12"



COLORED BODY PORCELAIN PAVERS - Rectified Monocaliber

MATT FINISH

### INTERNATIONAL WHITE

Available sizes



24" x 24"  
± 0.8" / 20 mm

Color shading



### MINIMALIST GREIGE

Available sizes



24" x 24"  
± 0.8"

Color shading



### RECOMMENDED USE

Masterplan matt finish is recommended for indoor floors, walls, countertops, and outdoor walls in commercial and residential applications. The use of Masterplan matt finish is not recommended for outdoor floors (for that application use Grip finish or Frontier20). Landmark recommends an offset no greater than 30%, if a staggered pattern is required for tiles of 20" inches or longer. Landmark recommends the use of leveler for a proper installation.

### CARE AND MAINTENANCE

Do not apply any wax or sealer to the product after installation. Regular cleaning is the best way to keep tiles looking good. Use clean, hot water (add household cleaner for more aggressive cleaning). Rinse thoroughly and dry with a soft cloth to prevent water spots. Please visit [lcusa.com](http://lcusa.com). For further information regarding the care and maintenance of Landmark products.

### WARRANTY

Landmark guarantees that its products will meet or exceed the performance specifications set out in ANSI A137.1- 2012 and in the performance specifications section of the Landmark general catalog. For more information, please visit our website at [lcusa.com](http://lcusa.com).

Color Shading



V1

UNIFORM APPEARANCE



V2

SLIGHT VARIATION



V3

MODERATE VARIATION



V4

SUBSTANTIAL VARIATION

The color of tiles printed in this catalog may differ from actual tiles. Tile color reproductions in this catalog are representative only. Slight tone and shade variations are inherent in porcelain tiles. Before selecting a color, we recommend that you contact your local representative, who will provide you with a sample piece of the requested tile.

This porcelain tile product is manufactured with a V2 shade variation. Remember that the amount of color as well as the texture of each piece may vary from tile to tile. Inspect the product immediately upon delivery and select tiles from many boxes during installation to minimize and blend any possible color difference.



### PROJECT

OUTDOOR FLOOR DESIGN

Frontier20 International White - 24" x 24"

Frontier20 Minimalist Greige - 24" x 24"













WALL DESIGN

Frame International White - 24" x 48"

Frame Neoclassical Beige - 24" x 48"



### COLORED BODY PORCELAIN TILE - Rectified Monocaliber

PHYSICAL PROPERTIES	TEST ASTM	NORTH AMERICAN STANDARD A137.1* / A137.3*	PORCELAIN TILES <small>(REF A137.1)</small>	PORCELAIN PAVERS FRONTIER20 <small>(REF A137.3)</small>
			RESULTS	RESULTS
 Water absorption *	C373	≤ 0.5%	COMPLY WITH ANSI A137.1	COMPLY WITH ANSI A137.3
 DCOF Average dynamic coefficient of friction **	ANSI A.326.3	As reported	IW - Interior, Wet	EW - Exterior, Wet
 Skid Resistance	EN 16165 (EX DIN 51097)	-	-	A+B+C
	EN 16165 (EX DIN 51130)			R11
 Resistance to freeze/thaw cycling *	C1026	As reported	RESISTANT	RESISTANT
 Resistance to thermal shock	C484	As reported	RESISTANT	RESISTANT
 Warpage (edge)	C485	Warpage ± 0.4% or ± 0.05 in	COMPLY WITH ANSI A137.1	COMPLY WITH ANSI A137.3
 Warpage (diagonal)	C485	Warpage ± 0.4% or ± 0.07 in	COMPLY WITH ANSI A137.1	COMPLY WITH ANSI A137.3
 Wedging	C502	± 0.25% or ± 0.03 in	COMPLY WITH ANSI A137.1	COMPLY WITH ANSI A137.3
 Chemical resistance	C650	As reported	UNAFFECTED	UNAFFECTED
 Resistance to stain	C1378	As reported	UNAFFECTED	UNAFFECTED
 Thickness	C499	Range: 0.04 in	COMPLY WITH ANSI A137.1	COMPLY WITH ANSI A137.3
 Breaking strength	C648	250 lbf or greater	COMPLY WITH ANSI A137.1	-
	C1050	2000 lbf	-	COMPLY WITH ANSI A137.3
 Module of Rapture	C1050	5000 psi	-	COMPLY WITH ANSI A137.3

\* Average values referred to our production and related to the matt finish of the product.

\*\* As far as values relating to the matt finish of the product and to tests carried out by certified external laboratories whose results are available upon request at Headoffice, we are willing to check the lot you are interested in purchasing.

- Be sure to use tiles belonging to the same caliber.
- Test results are available on request.
- The information provided can be subject to change. Please refer to [lcusa.com](http://lcusa.com) for the latest, most accurate and up-to-date information.







**Landmark Ceramics - UST, Inc.**

1427 N. Main Street  
Mount Pleasant, TN 38474

---

Tel. 931.325.5700

[lcusa.com](http://lcusa.com)

LEARN MORE ABOUT

